

# Railway Wheels

Quality Standart  
EN 13262+A2

Steel Grades  
ER7  
ER8

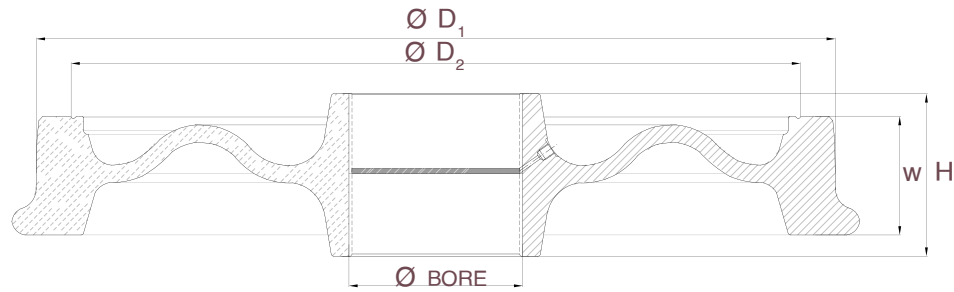

Product Name	Product	Wheel Type	TSI Certificate	Tread Diameter (D <sub>1</sub> ) (mm)	Center Diameter (D <sub>2</sub> ) (mm)	Rim Width (w) (mm)	Hub Width (BORE) (mm)	Hub Width (H) (mm)	Steel Grade	Standard	Axle Load (t)
BA303	Freight Wagon	78-K-101	+	920	840	135	200	185	ER7	EN 13262+A2	25
		78-K-264	-								
BA004	Freight Wagon	78-K-99	+	920	840	135	200	185	ER7	EN 13262+A2	22,5
		78-K-132	+								
		78-K-207	-								
Y32	Freight Wagon	78-K-184	-	920	840	135	185	170	ER7	EN 13262+A2	20
Y25	Freight Wagon	78-K-140	-	920	840	135	185	185	ER7	EN 13262+A2	20
		78-K-182	-								
Y25 Schileren	Freight Wagon	78-K-183	-	920	840	135	185	190	ER7	EN 13262+A2	20
Marmaray	Passenger Wagon	78-K-139	-	860	785	135	204	178	ER8	EN 13262+A2	18